

# Blind Flanges

# ANSI B16.5

# 150 Lbs

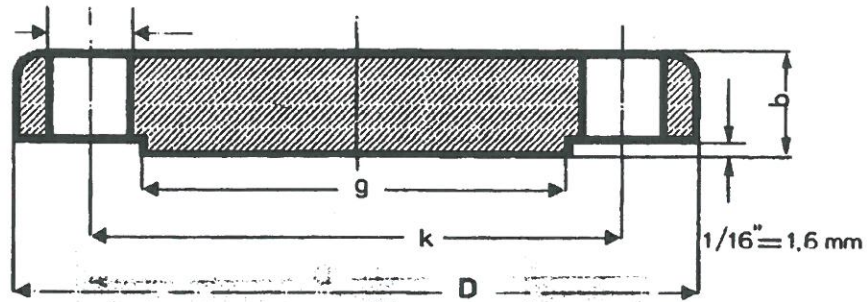

nominal pipe size	outside diam. of flange D	thickness of flange b	diam. of raised face g	drilling template			stud bolts			approx. weight kilo
				diam. of bolt circle k	n° of holes	diam. of bolt holes i	diam.	length		
								1/16" raised face	ring joint	
1/2"	88.9	11.1	34.9	60.3	4	15.9	1/2	2 1/2	-	0.8
3/4"	98.4	12.7	42.9	69.8	4	15.9	1/2	2 1/2	-	0.9
1"	107.9	14.3	50.8	79.4	4	15.9	1/2	2 3/4	3 1/4	1.0
1 1/4"	117.5	15.9	63.5	88.9	4	15.9	1/2	2 3/4	3 1/4	1.3
1 1/2"	127.0	17.5	73.0	98.4	4	15.9	1/2	3	3 1/2	3.0
2"	152.4	19.0	92.1	120.6	4	19.0	5/8	3 1/4	3 3/4	1.8
2 1/2"	177.8	22.2	104.8	139.7	4	19.0	5/8	3 1/2	4	3.2
3"	190.5	23.8	127.0	152.4	4	19.0	5/8	3 3/4	4 1/4	4.1
3 1/2"	215.9	23.8	139.7	177.8	8	19.0	5/8	3 3/4	4 1/4	5.9
4"	228.6	23.8	157.2	190.5	8	19.0	5/8	3 3/4	4 1/4	7.7
5"	254.0	23.8	185.7	215.9	8	22.2	3/4	4	4 1/2	9.1
6"	279.4	25.4	215.9	241.3	8	22.2	3/4	4	4 1/2	11.8
8"	342.9	28.6	269.9	298.4	8	22.2	3/4	4 1/4	4 3/4	20.4
10"	406.4	30.2	323.8	361.9	12	25.4	7/8	4 3/4	5 1/4	31.8
12"	482.6	31.7	381.0	431.8	12	25.4	7/8	4 3/4	5 1/4	50.0
14"	533.4	34.9	412.7	476.2	12	28.6	1	5 1/4	5 3/4	60.0
16"	596.9	36.5	469.9	539.7	16	28.6	1	5 1/2	6	77.0
18"	635.0	39.7	533.4	577.8	16	31.7	1 1/8	6	6 1/2	95.0
20"	698.5	42.9	584.2	635.0	20	31.7	1 1/8	6 1/4	6 3/4	123.0
22"	749.3	46.0	641.2	692.1	20	34.9	1 1/4	7	7 1/2	151.0
24"	812.8	47.6	692.1	749.3	20	34.9	1 1/4	7	7 1/2	187.0